

# KELLY

WINDOW SYSTEMS INC.

## TILTING INSTRUCTIONS FOR THE KELLY VANGUARD

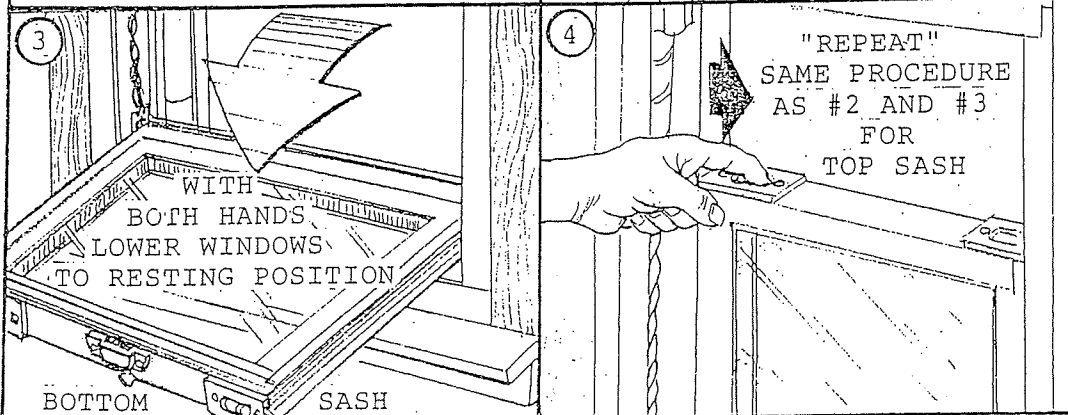
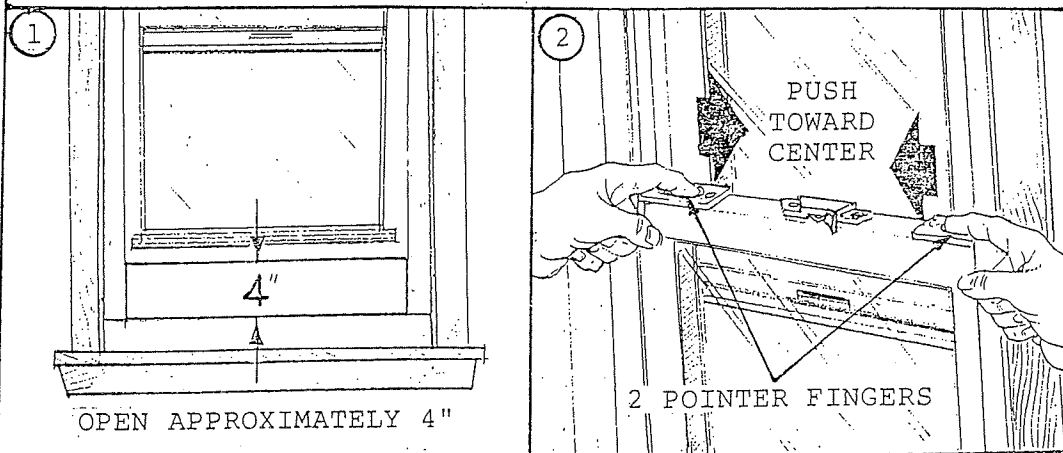

- 5 TO RETURN THE SASHES TO THEIR ORIGINAL POSITIONS, GENTLY LIFT, USING BOTH HANDS, AND PUSH THE TOP OF THE SASH BACK INTO THE WINDOW FRAME AREA. MAKE SURE THE TILT PLUNGERS HAVE ENGAGED BOTH JAMBS SECURELY. IF NECESSARY, MANUALLY ENGAGE THE TILT PLUNGERS BY PUSHING THEM INTO THE JAMB FRAME.